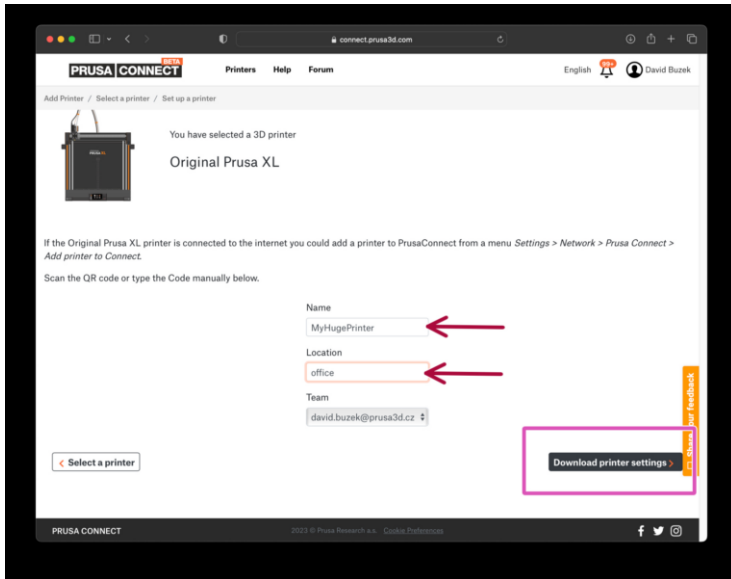

Table of Contents

Adding the printer to Prusa Connect (XL firmware up to 4.7.5)	3
Step 1 - Introduction	5
Step 2 - Turn on Prusa Connect	6
Step 3 - Adding the printer to Prusa Connect	7
Step 4 - Preparing the printer	8
Step 5 - Uploading G-code to Prusa Connect	9
Step 6 - Printing from Prusa Connect	10
Step 7 - Prusa Connect file management	10

Adding the printer to Prusa Connect (XL firmware up to 4.7.5)



help.prusa3d.com/g420001

**Scan the QR code to
display the latest
version of this
chapter.**



STEP 1 Introduction

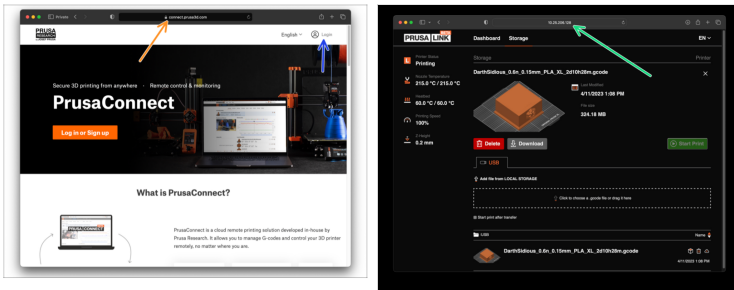

- In order to be able to control a printer from anywhere in the world, you have to add your printer into PrusaConnect.
- This guide is valid for **Original Prusa XL** machines running

If you plan to use another printer type or just crave for more info, visit the Prusa Connect and PrusaLink explained article.

 **This guide is valid for **firmware versions up to 4.7.5 only!** Prusa Connect requires printer firmware version 4.7.1 or newer.**

- First, make sure your printer successfully connected to the Internet and **PrusaLink** for the given printer works.
- Visit [Connect.Prusa3D.com](https://connect.prusa3d.com) website and **log in** using your Prusa Account.

STEP 2 Turn on Prusa Connect



- ◆ On your printer, navigate to **Settings > Network > Prusa Connect**
- ◆ Set PrusaConnect to **Enabled**.
- ◆ Select **Add Printer to Connect**
- ◆ Wait until the unique Prusa Connect Code is generated.
 - ◆ **Scan the QR code with your phone** or write down the code for manual entry.
- ⚠ **Do not hit the Leave button on the printer yet!! Otherwise, it won't be able to Connect.**
- ℹ If the printer failed to obtain the Code and the Registration failed screen appears, verify the network connection, **perform a factory reset** and repeat the process until the Code appears.

STEP 3 Adding the printer to Prusa Connect

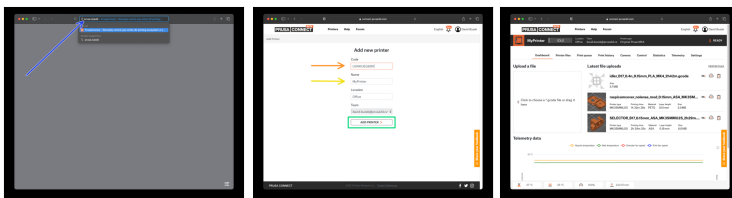

- i In case you have scanned the QR code, you can follow the instructions on your screen and skip this step.
- In your browser, navigate to Prusa.io/add page.
- Type in the Code.
- Add up the Name and Location description for the printer.
- Select Add printer.
- Now, you will get to the printer's details page.

Adding the printer to Prusa Connect (XL firmware up to 4.7.5)

STEP 4 Preparing the printer



- Make sure the printer is ready to print:
 - There must be a **USB drive** in the printer.
 - An empty, clean and degreased steel **sheet must** be attached on the heatbed.
- The printer must be on the home screen. If there is any prompt on the LCD screen, the printer will reject any remote command.**

Adding the printer to Prusa Connect (XL firmware up to 4.7.5)

STEP 5 Uploading G-code to Prusa Connect

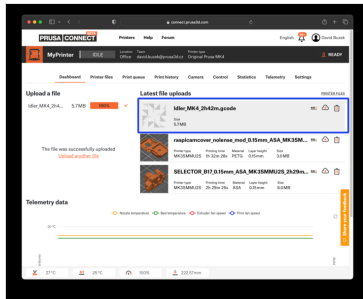
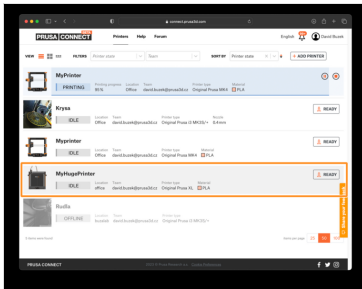

- 🟠 Wait until the printer status in Prusa Connect is **IDLE**. Open up the printer details.
- 🟡 Drag&drop a **G-Code** file you wish to print into the marked area of the page.
- 🟢 After the file uploads to Prusa Connect successfully, it will appear in the **Latest file uploads** section.

STEP 6 Printing from Prusa Connect

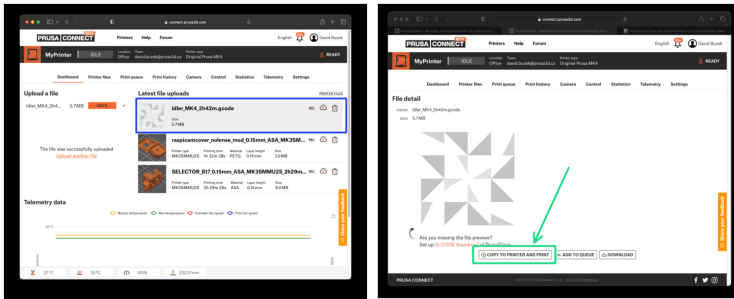

- Open the **file details** page.
- Select **Copy to printer and print**.
- i** Since Prusa Connect is a cloud service, the file is stored on a server and must be copied over to the printer before it can be printed on it.

STEP 7 Prusa Connect file management

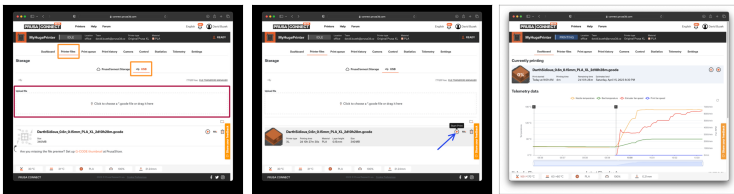

- To browse the files stored on the printer, visit the **Printer Files > USB** (in case of MK4 or XL)
- On this page, you are able to browse the files already **stored on the printer** itself.
- To upload a file directly to the printer, simply drag it into the marked area on this page.
- By hitting the **Start Print** button, you can start printing immediately.
